

© Crown Copyright 2009
 Reproduction in whole or in part is prohibited
 without the prior permission of Ordnance Survey.

Notes

1. All dimensions are in metres unless otherwise stated.
2. All traffic management to comply with Chapter 8 and any updates, and Safety at Street, Works and Roadworks (A code of practice)
3. All road markings and signs to be as per the Traffic Signs Regulations and General Directions, 2002.
4. All permanent traffic signals will be bagged and switched off at all times that temporary traffic signals are being used. This should be done with approval from said authority.

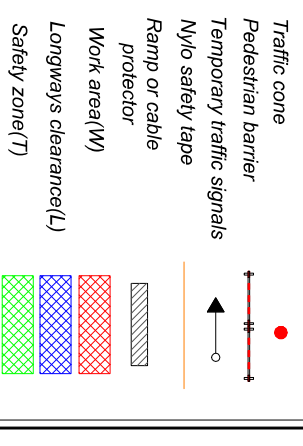

Rev	Date	Purpose of revision	Drawn	Checked/Approved
1	18/2/11		NR	
0	17/12/10			
0	17/12/10			

Merryn Lambert Plant Ltd.
 Millpond Farm,
 Millpond,
 Nuneaton,
 Warwick, CV10 6JH
 Tel: 01922 258114
 Fax: 01925 868255



Cambridge
 Gas Mains Replacement

Downing Street/Tennis Court Road

Drawing status	Scale	Client ref. no.	Page No.	Drawing number
	NTS		01	MLPP/1073/CMR/06
	DO NOT SCALE			0

This drawing is not to be used in whole or part other than for the intended purpose and project as defined on this drawing. Refer to the contract for full terms and conditions.